



This PDF is generated from authoritative online content, and is provided for convenience only. This PDF cannot be used for legal purposes. For authoritative understanding of what is and is not supported, always use the online content. To copy code samples, always use the online content.

# Genesys Engage cloud Supervisor's Guide

Contact management (v8)

# Contact management (v8)

## Important

This content may not be the latest Genesys Engage cloud content. To find the latest content, go to [Genesys Engage cloud for Supervisors](#).

When you need help to resolve a customer issue or you need to transfer the call, use the Team Communicator to locate the contact you need to reach. You can also use the Team Communicator to initiate a call. The contacts in the Team Communicator are already set up for you to use; however, you can add contacts and mark contacts as favorites. After you learn how to navigate the Team Communicator, you should be able to locate your contacts quickly and reduce the amount of call time you use to search for contact.

To open the Team Communicator, click **Team Communicator** .

## Find a contact

Toolbar includes:

Search all

Favorites

Recent contacts

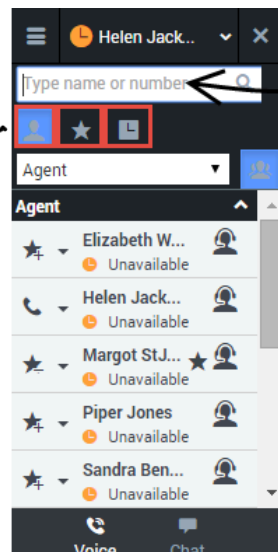

type here to filter the contact list

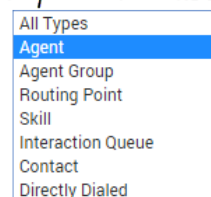

select a group from the drop-down list box



The Team Communicator provides several ways to find a contact.

- Type a name or number in the text field to filter the contact list. The contact list filters the list for you as

you type, even if you only type part of a name. For example, if you want to locate the contact for Sandra, you can type San and the list shows all contacts with San in the name.

- The toolbar enables you to:
  - —List all contact types
  - —List your personal and corporate favorite
  - —List recent contacts
- The drop-down list box enables you to display categories of contacts, such as agent groups, routing points, skills, and other such groupings.

Favorite contacts have a star  next to the contact name. Corporate favorites are contacts that marked as favorite by an administrator for use with all agents in your agent group or contact center.

### Adding a new contact

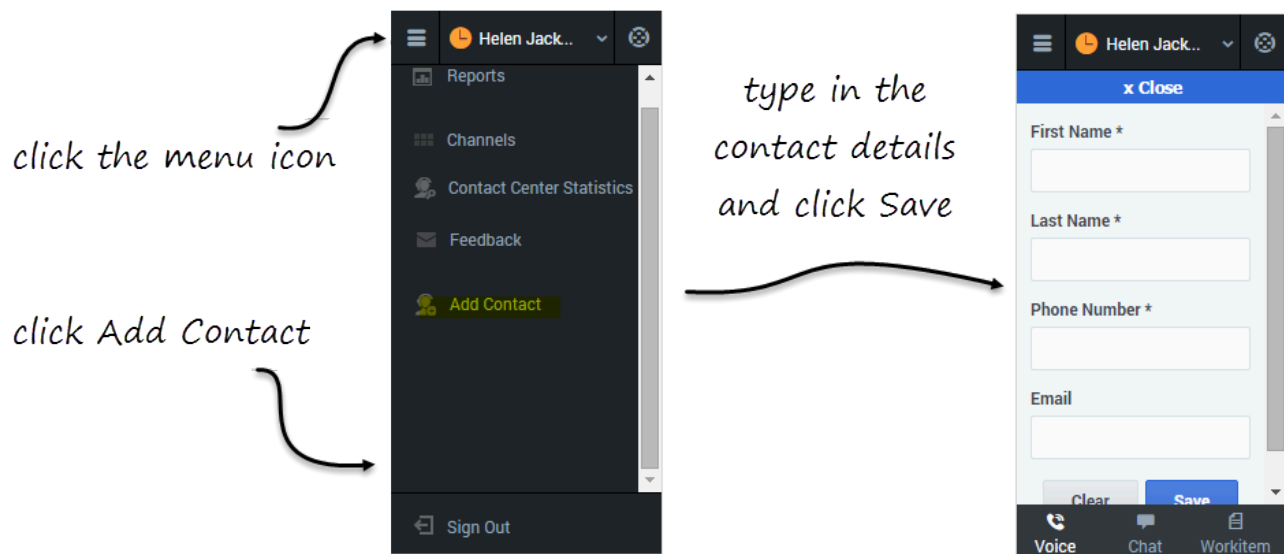

Sometimes, you might need to add contacts to your contact list. For example, you can add an external contact.

Open the **Add Contact** panel from the main menu and fill out all mandatory fields and the email address. After you click **Save**, a confirmation message is displayed.

#### Tip

Ensure that you give your contact a unique name. If you have two more entries with

the same name, it will be difficult for you to pick which one to call. If you have more than one contact name with the same name, consider appending the last name. For example: John Smith (cell) and John Smith (office).

You can further verify that the contact was saved by opening the Team Communicator and typing your new contact's name in the search bar. The contact should appear in the list of results.

## Add a new contact as a favorite

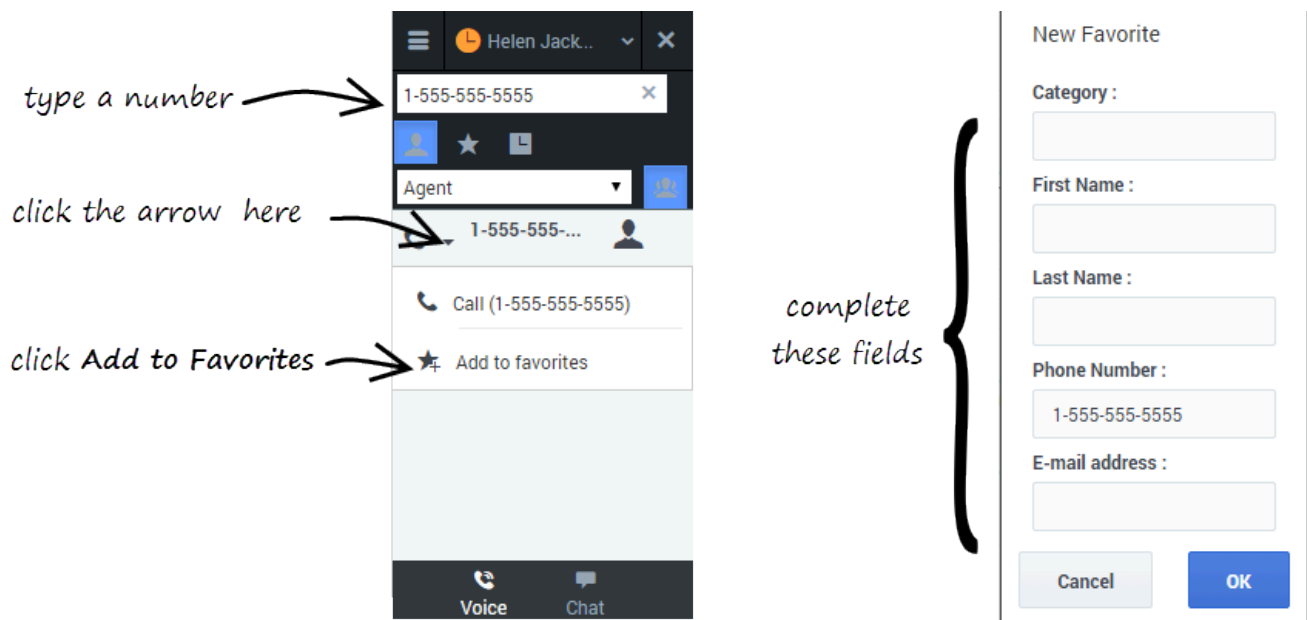

When you type a phone number in the Adapter, the Team Communicator recognizes whether the number is already in your contact list or not. If the typed number isn't already a contact, a new entry is added to the contact list. Click the drop-down menu next to the number and select **Add to Favorites**.

## Mark an existing contact as a favorite

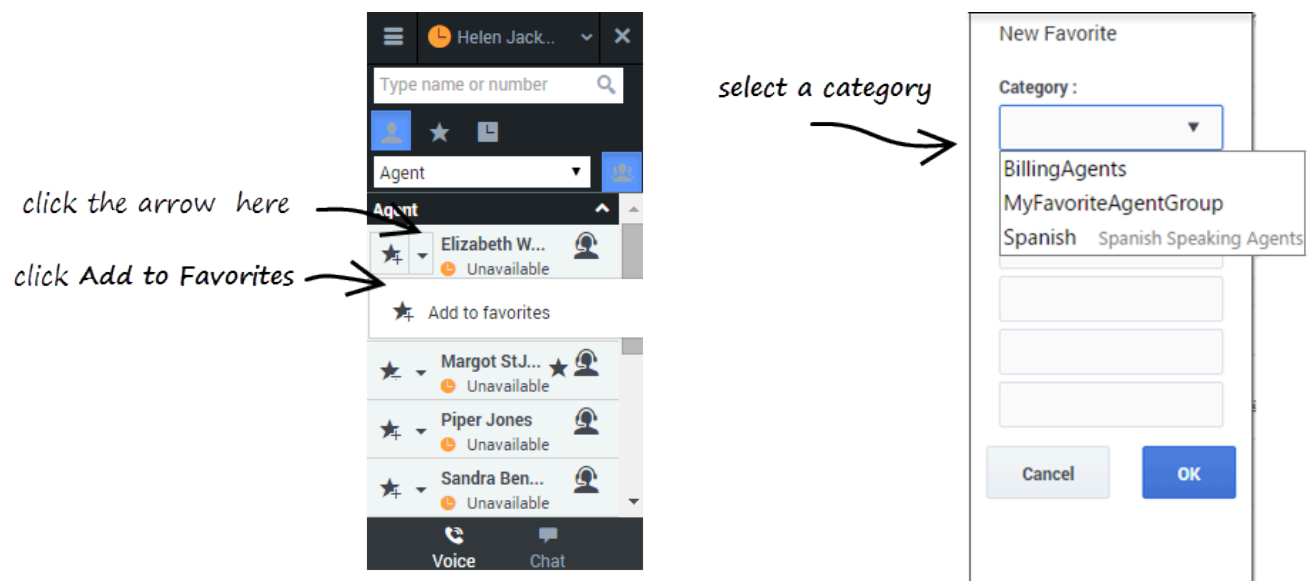

If you find yourself calling the same contact frequently, you can add the contact to your favorites list. Select the contact that you want to mark as a favorite, click the drop-down menu next to the number, and select **Add to Favorites**.